



PG32GR



适用范围/Typical applications:

遥控窗帘、微型数控设备、中央空调调节阀、机器人、柔巾机、舞台灯光、电脑座便器专用阀门电机、电动广告、可调角度望远镜、办公设备、家用电器、自动执行器。

Auto shutter, Micro CNC equipment, Central air-conditioning valve, Robots, Towel dispensers, Limelight, Automatic closet bowl special valve, Electric advertising, Angular telescope, Office equipment, Household appliances, Automatic actuator.

外形尺寸图/Appearance size

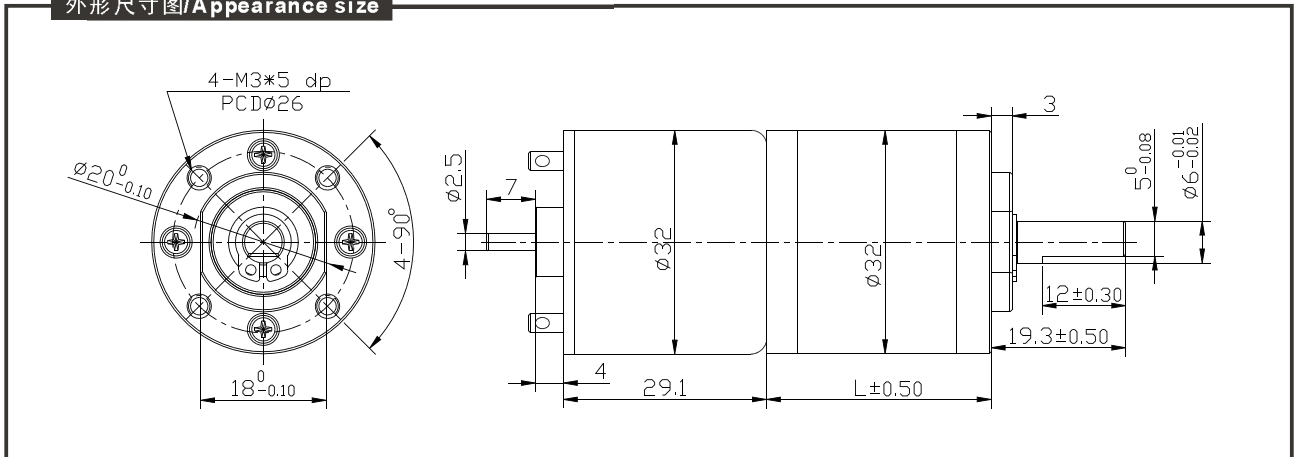

齿轮箱清单/Gearbox data:

| 级数 Number of stages | 1 stages reduction | 2 stages reduction | 3 stages reduction | 4stages reduction | 5stages reduction |
|-------------------------------------|-----------------------|-----------------------|-----------------------|--------------------------|----------------------------------|
| 减速比Reduction ratio | 3.3, 4.6 | 11.2, 15.5, 21.5 | 37.7, 52.1, 72, 100, | 126, 174, 241, 334, 462, | 423, 585, 810, 1120, 1549, 2142, |
| 齿轮箱长度 Gearbox length "L" mm | 20.7 | 26.4 | 32.2 | 38 | 43.8 |
| 最大额定力矩 Max. Running torque | 5.0Kgf · cm | 10.0Kgf · cm | 25Kgf · cm | 25Kgf · cm | 25Kgf · cm |
| 最大损坏扭力 Max. Gear breaking torque | 15.0Kgf · cm | 30.0Kgf · cm | 75Kgf · cm | 75Kgf · cm | 75Kgf · cm |
| 效率Gearing efficiency | 90% | 81% | 73% | 65% | 59% |

马达清单/Motor data:

| 马达型号 Motor name | 额定电压 Rated Volt. V | 空载No load | | 负载扭矩Load torque | | | | 堵转扭矩Stall torque | |
|--------------------|--------------------------|-----------|-------|-----------------|-------|---------|--------------|------------------|---------|
| | | Current | Speed | Current | Speed | Torque | Output power | Torque | Current |
| | | mA | r/min | mA | r/min | gf · cm | W | gf · cm | mA |
| GR124500 | 12 | ≤90 | 4500 | ≤220 | 3589 | 67.6 | 2.5 | 358 | 1500 |
| GR127000 | 12 | ≤140 | 7000 | ≤700 | 5647 | 79.7 | 4.6 | 472 | 3030 |
| GR244500 | 24 | ≤50 | 4500 | ≤160 | 3539 | 60 | 2.1 | 281 | 596 |
| GR246700 | 24 | ≤70 | 6700 | ≤280 | 4500 | 78.4 | 4.23 | 381 | 1140 |

1、 减速后的输出力矩 = 马达力矩 X 减速比 X 齿轮效率。输出转速 = 马达转速 / 减速比。
 1、 After connecting motor and gearbox which is named gearmotor the output torque: motor torque X reduction ratio X gearing efficiency; output speed: motor speed / reduction ratio.

NOTE:

- 1、 马达命名: 如PG32GR244500-72K。马达参数如马达清单上的GR244500, 齿轮减速比参数如齿轮箱清单上的72, 马达的输出转速和输出力矩请参照上表的马达清单。
- 2、 马达可安装的译码器参数请参照第46页。
- 3、 标准输出轴为Φ6.0mm, 其它尺寸可根据客户要求制作。
- 4、 以上参数仅作参考, 具体以实物为准。
- 1、 Gearmotor named methods: e.g. PG32GR244500-72K Motor please refer to the motor data GR244500. Geabox please refer to gearbox data reduction ratio 72. Related to gearmotor output speed and torque please refer to motor data.
- 2、 Motor can be installed with magnetic encoder, encoder parameters please refer to Page 46.
- 3、 Standard output shaft after reducing: .0mm. other sizes of the output shaft can make as client request.
- 4、 Chart only for reference, products shall prevail the entity.